

- PARCEL IDENTIFICATION NUMBER: 27-3n-19-19000-001-0006
- BOUNDARY AREA: 629,529 SF OR ±14.452 ac.  
0.0 SF OR ±0.0 ac. (WETLAND AREA)  
629,529 SF OR ±14.452 ac. (UPLAND AREA)
  - AREA SURFACE:  
PROJECT LIMITS = 112,990 SQ.FT.  
IMPERVIOUS AREA = 32,635 SQ.FT. (XXX REF. TO PROJECT LIMITS)  
IMPERVIOUS AREA = 173,635 SQ.FT. (XXX REF. TO BOUNDARY AREA)  
PERVIOUS AREA = 80,355 SQ.FT. (REFERENCE TO PROJECT LIMITS)  
PERVIOUS AREA = 455,894 SQ.FT. (REFERENCE TO BOUNDARY AREA)
  - PROTECTED TREES:  
0
  - BUILDING AREA:  
.98 Acres = 42,995 SQ.FT.  
FLOOR AREA RATIO = 6.8%
  - BUILDING SETBACKS REQUIRED:  
FRONT = NA FL. (XXX)  
SIDE = NA FL. (XXX)  
REAR = NA FL. (XXX)
  - BUILDING SETBACKS PROVIDED:  
FRONT = NA FL.  
SIDE = NA FL.  
REAR = NA FL.
  - ZONING: AGRICULTURE
  - PARKING PROVIDED:  
TOTAL = 66 SPACES
  - ALL STRIPING AT HANDICAP PARKING SHALL BE BLUE. ALL OTHER STRIPING SHALL BE WHITE.
  - INSTALL CONCRETE CONTRACTION JOINTS ON 10'-0" CENTERS, EXCEPT SIDEWALKS. SIDEWALK CONTRACTION JOINTS ARE TO BE ON 5'-0" CENTERS.
  - INSTALL 1/2" THICK EXPANSION FIBER BOARD BETWEEN THE SIDEWALKS AND OTHER CONCRETE STRUCTURES.
  - ALL PERVIOUS SURFACES SHALL BE SEEDED AND MULCHED MINIMUM.
  - CONTRACTOR SHALL VERIFY LOCATIONS OF ALL PROJECT UTILITIES, BURIED AND ABOVE GROUND REGARDLESS OF INCLUSION ON THESE PLANS. ALL CONTRACTOR DAMAGED UTILITIES SHALL BE REPAIRED AT CONTRACTOR'S EXPENSE.
  - ANY EXISTING DEBRIS AND/OR EXISTING STRUCTURES SHALL BE COMPLETELY REMOVED PRIOR TO THE CONSTRUCTION.

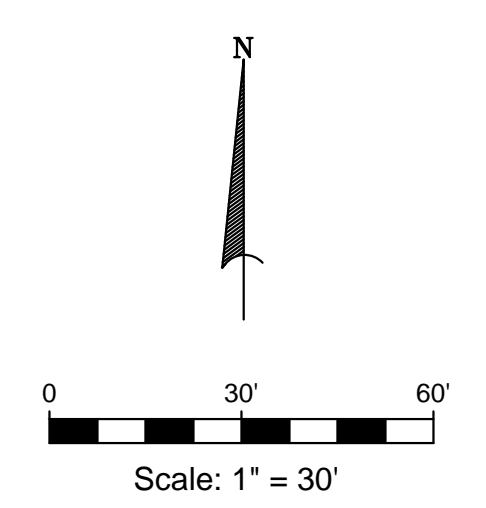

TBM  
634067.79  
1456689.78  
240.97  
CONC. MON

TBM  
633927.81  
1456992.43  
237.24  
SET NAH

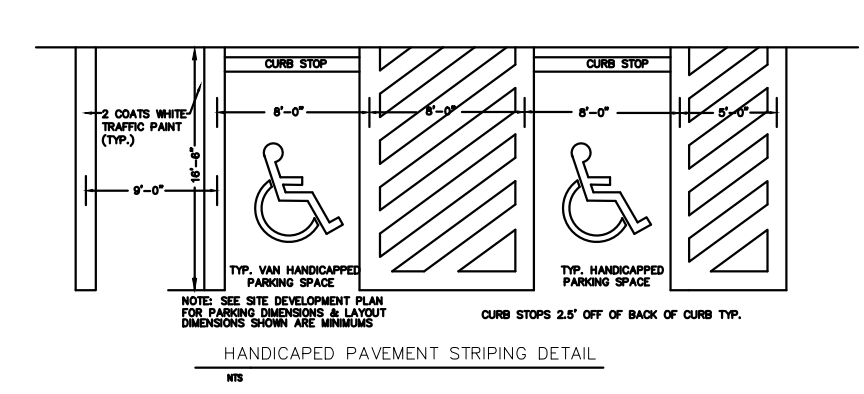
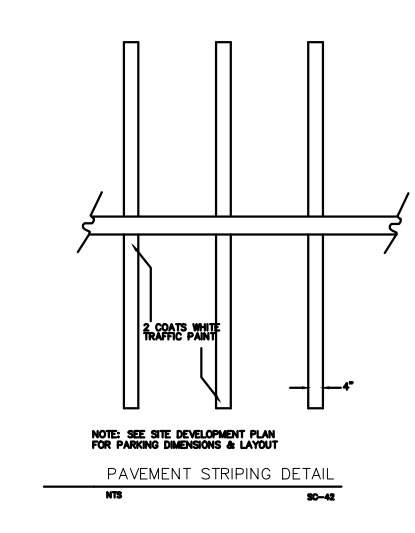
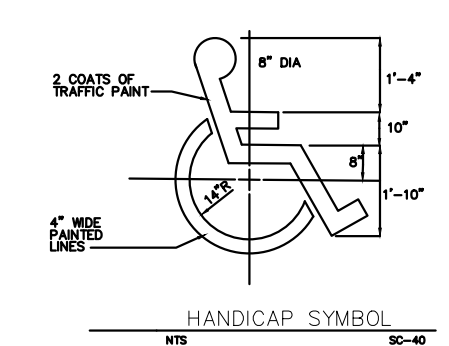
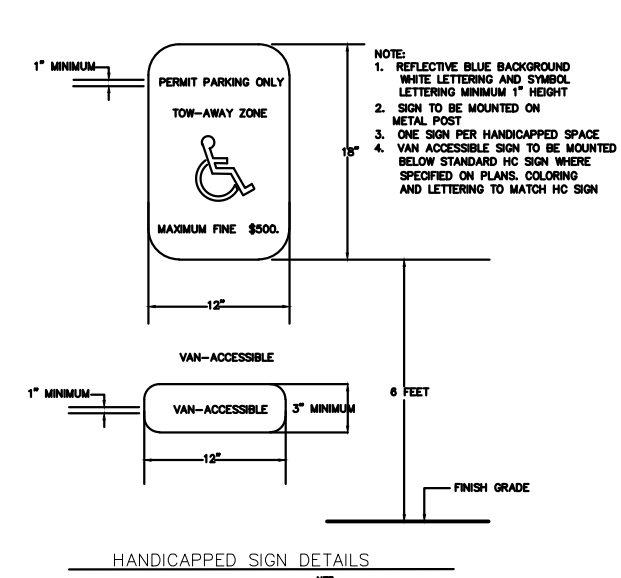
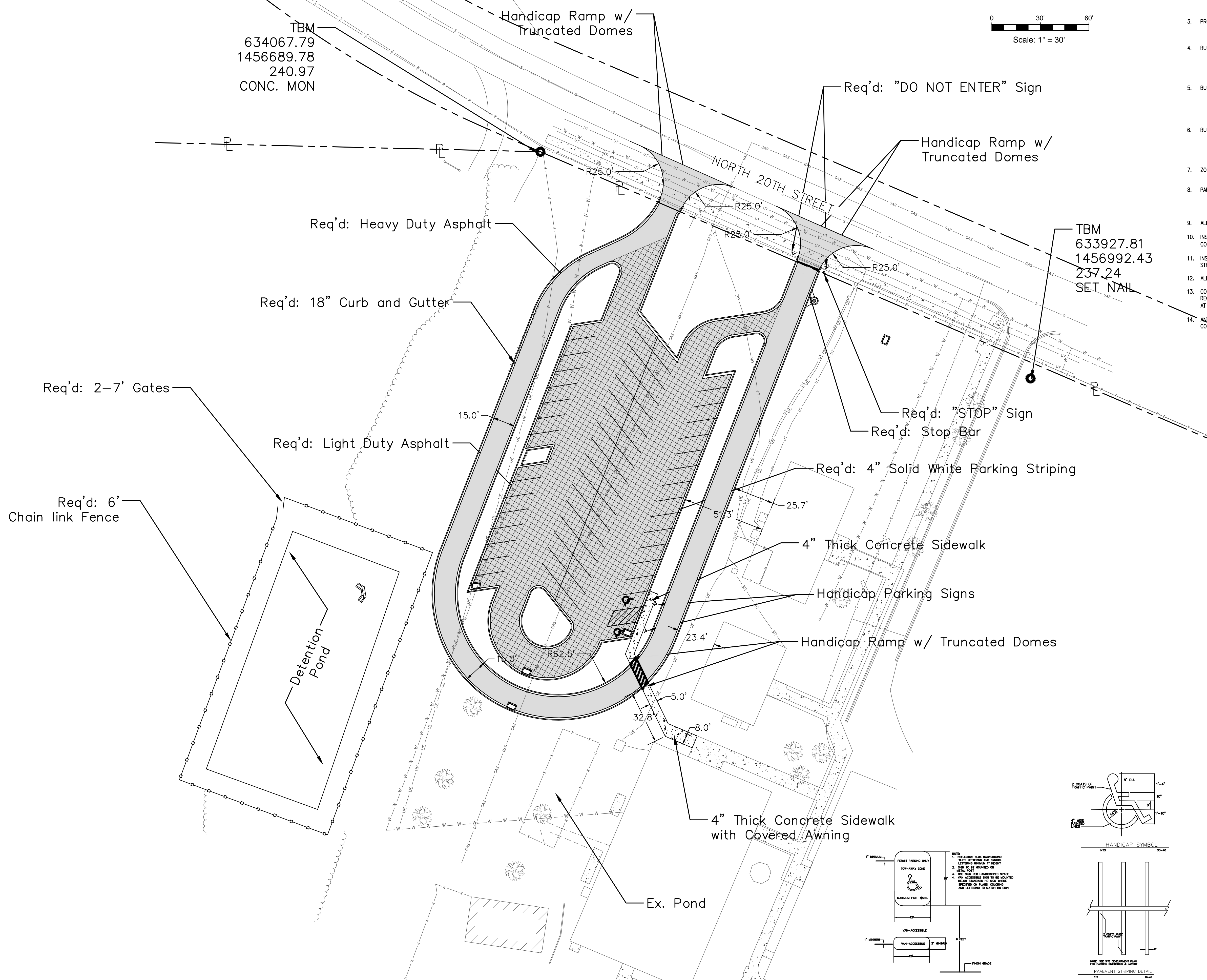

ISSUE	DATE
OWNER REVIEW	06/09/14
90% SUBMITTAL	10/01/14
ADDENDUM	01/29/15
drawn by:	JWS
checked by:	

WALTON COUNTY  
CAREER DEVELOPMENT CENTER  
DeFuniak Springs, FL

CMOB140023

CONSTRUCTION